

The MUZZLEBLAST

Florida's Largest Gun Club, over 4,000 and growing...

2015 Quarterly publication of the Gateway Rifle and Pistol Club of Jacksonville, FL.

1st Quarter

Junior shooter, Abbey Wensell, qualified by score to be invited to the April 2015 Junior Olympics at Colorado Springs, CO.

This is a pretty impressive achievement. Abbey has a USA Shooting site which is asking for donations to defray the costs for her and her father can travel to the five day event.

Letter from Abbey:

Dear Club Members and Staff,

First of all I want to say THANK YOU to Gateway Rifle and Pistol Club for having a program that introduces young people to the sport of shooting. I came to Gateway in the fall of 2013 as a junior shooter, and have grown to love the sport. After participating in the Florida Junior Olympic Qualifier in Orlando last month, I am very excited to share with you that I've been awarded the opportunity to travel to Colorado Springs, CO in April to compete in the USA Shooting National Junior Olympic Championships. I will be one of only a few hundred shooters to compete at the Olympic Training Center in Colorado Springs. National Junior Team spots are on the line for top finishers at this event, offering me the possibility of competing internationally to represent the USA.

With travel costs increasing each year, my 2015 goal is to raise \$2,500 to help pay for accommodations, entry fees, training supplies and travel expenses to this competition.

Keep me in your prayers as I prepare mentally and physically for this new endeavor. I hope that you will consider a gift to support my participation in this prestigious event. Any amount is GREATLY appreciated.

If you would like to donate and learn more about USA Shooting National Junior Olympic Program please visit:

<https://donate.usashooting.org/e/awensell>

Sincerely, Abigail Wensell



Abbey Wensell, qualified by score to be invited to the April 2015 Junior Olympics



Lost and Found

This is a reminder to our club members that if you find anything left on the range by your fellow members, club policy requires that it turn it in to a Range Safety Officer or to the Office Staff immediately so that it can be secured in the club office. This saves a lot of time and effort on the part of club employees and officers in trying to track down and locate missing items with the surveillance cameras as well as minimizing stress on our members who have lost items.

Randy Erickson – Secretary/Treasurer

Gateway Rifle & Pistol Club
 9301 Zambito Ave. N., Jacksonville, FL 32210
 904-771-2937
 Business Manager
 Business-mgr@grpc-jax.com

BOARD OF DIRECTORS

Officers

President Bill Craig 737-5252
Vice President Sam Grimes 207-3587
Secretary Randy Erickson 448-3174
Treasurer Randy Erickson 448-3174
P R Officer Alan Way 276-3559

Board Members

ArvilBudd 777-6932 buddarvil@aol.com
 Dana Baygents 403-9605 baygents@comcast.net
 Braley Carroll 614-3097 Sitkinak08@yahoo.com
 Gary Matthews 396-9526 getannem@gmail.com
 Russ Misner 1-904-284-5347 misnerr@Bellsouth.net
 Allen Way 276-3559 allenway@comcast.net
 Robert Kindl 398-0763
 Don Hardeman 631-9458
 Toby Nolan 284-8164
 Tim Allen 483-7396

Disclaimer

The Muzzleblast is published quarterly by Joan Zullo under the direction of the Gateway Rifle & Pistol Club. All newsletter content will be approved by the GRPC before publishing. Technical and/or hand loading data are for informational purposes only. No responsibility is accepted for results obtained by persons using such data, and all liability for any consequential injuries or damages is disclaimed. References herein to any specific commercial product, process or service by trade name, trademark, manufacturer or otherwise, does not necessarily constitute nor imply endorsement, recommendation nor favoring by The Gateway Rifle & Pistol Club, Inc., its Board of Directors, its membership, the editor, nor the publisher. Letters to the editor should be brief, to the point, of firearm related interest and contain the signature, address and telephone number of the sender. Letters to the editor do not necessarily reflect the views of the editor, publisher or Gateway Rifle & Pistol Club. Send submissions to: Gateway Rifle and Pistol Club, 9301 Zambito Ave. N, Jacksonville, Fl. 32210, or to the Muzzleblast editor at: editor@grpc-jax.com.

<http://www.GRPC-JAX.com>



(Left) Gateway Junior shooter Annie Davis who has made Distinguished Expert International Air-Rifle
 (right) Marion Estes Junior's shooting instructor

~~~~~  
**Concealed Weapon and Firearm License Class Offered at GRPC**

This class is offered the first Saturday of each month (holidays permitting) and begins at 0830. The cost is \$35 per person for GRPC members, \$40 per person for non members.

The course meets the State of Florida's requirements for application to obtain a CWFL. It is taught by certified NRA Instructors, but is not an NRA course, although it does meet the requirements to obtain a CWFL in Florida. The course is about three and a half hours long. A notary and photograph are available.

Live fire at seven yards is required. You will need a handgun and 15 rounds of appropriate ammunition, plus vision and hearing protection. Limited coaching/instruction provided as needed on the firing line. The course emphasizes gun safety and familiarization. If you plan on carrying, you have the obligation to be competent in use. Stress fire reduces the operator to the lowest level of their training. The firing line procedures and class instruction operate on the assumption nobody has held a handgun before, don't get your feelings hurt. No gun? If possible, note that when preregistering, we can supply a limited number.

The financial proceeds go to our Junior Club's operation.

You may pre-register at the club office.

Thanks, Marion Estes

## NOTES FROM YOUR CLUB PRESIDENT

These past two years have seen a dramatic change in our Club's ranges and operations.

Some of the most notable are:

1. We moved the Bulls eye pistol competition range from its old location (range# 1) to the far northern area of our property west of range # 7. We built a state of the art pistol competition range with excellent turning targets, 25 firing points, covered overhead, a "stat" office, and concrete walkways with good water drainage. This Bulls eye range is also suitable for 17/22 rim fire rifle shooting or rifles chambered for pistol cartridges such as those used by the "Cowboy" Single Action Shooting Society (SASS) at 25 and 50 yards.
2. The former Bulls eye range was converted to seven (7) and fifteen (15) yard pistol/revolver firing points in five bays. These bays are designed for multiple shooters within each bay. To keep bullets on our property, a large "billboard" was constructed across the top of existing dirt berms. Overhead covers were built over the bullets impact areas to prevent "pop-ups" from leaving the range. These firing points are open for use by our day members as well as annual/life members.
3. We had requests for high power rifle targets at 25 and 50 yards instead of just 100 and 200 yards. To do this safely and keep bullets on our property, bullet traps at 25 and 50 yards were installed on rifle ranges #2, #3, # 4A and # 8. Now we have high power rifle targets at 25, 50,100 and 200 yards. Only range # 2 is open to our day members with rifles or shotguns while all the other rifle ranges are reserved for annual/life members. Range # 2 has a special bullet trap for testing home defense type shotguns.
4. Range # 8 for annual/life members only with only 12 firing positions seemed overcrowded at times. Also we had member requests for off hand shooting with a high power rifle at 100 yards. So a new 100 yard high power range with 12 positions was built on the west end of the seldom used portion of the silhouette range. Firing can be done there off hand as well as bench shooting. This range also has a "billboard" on top of the dirt berm and overhead cover at the bullet impact area.
5. Range # 4B used for silhouette and competition 22 rim fire shooting was rebuilt with user friendly target frames. A concrete wall separates range #4 B from Range # 5 A. This wall was built to protect shooters down range at the target area on Range # 4 A from possible ricochets from Range # 5 A. This concrete wall between the ranges has a huge secure door for maintenance vehicle access. Huge signs are posted at Range #4 B and the driveway into Range # 5 which plainly state that NO high power rifle shooting is allowed past those signs into Ranges # 5 and # 7. For Club safety, only pistol/revolver cartridges. 17/22 rim fire and shotgun shells can be fired in those two ranges. Violators face loss of membership. We cannot afford to jeopardize our range because of a few people cannot follow Club safety rules.
6. The back all purpose ranges # 5 and # 7 had only seven shooting bays with three concrete walls, four dirt side berms and little Club member comforts. After rains, we had huge a muddy mess in many areas. Range # 5 was rebuilt with seven large shooting bays with steel plate racks, target frame holders and all bays have overhead shelters and picnic benches. Parking was greatly improved by gravelling the parking area in back of the bays. Drainage was improved by land grading, filling in low areas and creating a swale for rain overflow. Recent heavy rains have proved our drainage work and effort were very successful.
7. All purpose Range # 7 now has nine shooting bays for shorter bays from about 10 yards deep to about 20 yards deep designed for pistol/revolver/22 rim fire. A huge bill board on top of the dirt bullet impact berm as well as overhead covers will keep bullets on our property. Range use there is first come, first serve.
8. Both Ranges # 5 A-F and # 7A-H have target storage buildings.
9. The bathroom with flush toilets behind ranges # 1 A thru #1 E had its roof rebuilt.
10. The overhead roof extending over a distance of over 100 yards from Range # 2 to Range # 4B was in terrible condition with rotten plywood and numerous leaky holes. The entire overhead was rebuilt with metal roofing over new plywood and most all of the wooden support poles were replaced.
11. Ranges # 2 and 4A formerly had lakes after large rains. Storm drains were installed and again recent heavy rains have proved their worth.
12. New picnic tables were added to the Club's large covered pavilion which are very useful in our Club swap meets.
13. Our new assembly hall building is almost completed. When finished, this year, we will greatly expand our Club store and office area in our old building into what formerly was our assembly hall for yearly meetings.(Cont. page 4)

(cont. from page 3)

14. Within the next few weeks, our well water system, our chlorination equipment and septic tanks will be replaced with JEA city water and JEA city sewer systems. The huge mound which has a septic tank in back of range # 2 will be removed and thus increasing our parking area and closer access to the rifle firing positions. Our Club owned fire plug with its large blue water tank will be obsolete as we will have a city fireplug with city water available just outside of our Club entrance driveway.
15. We installed a video surveillance system throughout our Club ranges and property. This allows us to monitor Club activity when needed. Its usefulness has helped us several times when serious improper activity occurred on our premises. We, the Board of Directors, were then able to take appropriate action.

All of the above was paid for with retained earnings from previous years. As our facilities have greatly improved and shooting points have more than doubled, so have our maintenance and overhead costs for over 4,000 annual and life members. We have expanded our Range Safety Officer coverage as our membership and range attendance has increases. We also expanded our office staff to help eliminate long lines or members waiting to pay member fees or purchase items in our club store. Our maintenance staff now has three employees instead of two. The recent increase in membership fees was done to pay for our day to day operations, payroll, insurance and so on. Our basic operations with no capital improvements comes to almost \$2,000 per day. It may be hard to believe but that's what it costs.

All of the above has taken a huge amount of my time in 2014 and to date as well as the time our past President Randy Erickson in 2012 and 2013. Fortunately, we have a good staff of employees. Our day to day operations are managed by our Business Manager, Brenda Trickler and John Whitten, our Range Manager. The office staff report to Brenda. The maintenance staff and Range Safety Officer report to John.. Both Brenda and John report to me as Club President. All our employees are paid. Our Club officers and Board of Directors serve without pay. An occasional "thank you" to us might be well in order from our Club members. Club policies (by which we operate) and all Club expenditures require approval by our elected Board of Directors and officers. The Board meets on the second Monday of each month at 7:00 PM. All members are invited to attend and learn what is going on at our Club.

**Go to next page, page 5 to view map of the GRPC Ranges.**

That's all for now!

Bill Craig

President 2014-2015



## **From the Desk of Allen Way, GRPC Public Relations Officer**

January 12, 2015 was a very special day in the history of Gateway Rifle & Pistol Club. We had, as our guest speaker, the highly acclaimed Massad Ayoob, at our facility to do a seminar. The seminar was open to our members or to guests, who registered ahead of the program. It was two solid hours of in-depth classroom training, complete with a Power Point presentation detailing the point-by-point messages that Mr. Ayoob explained to us.

It was a "cradle to the grave" seminar. Since he was speaking primarily to those of us who already had experience with handguns, he did not have to go through, "This is a muzzle, this is a barrel, this is a trigger...". What he DID cover was serious details about how to avoid conflict, where the law covers your use of your handgun (car, home or business), and what to do once you have needed to use your weapon in a self-defense situation.

He gave easy, step-by-step, instructions on when to make the phone call to the police to let them know that there has been a shooting - what to say to the police once they have arrived - how to properly respond to the multiple questions that they WILL be asking - AND what it is going to be like in the courtroom when you have to be there to defend yourself, along with your legal counsel.

For those who missed the seminar, you missed a FANASTIC event. I encourage you to see this very knowledgeable man, in person, at one of his seminars as soon as possible. He also does what I call "intensified training", that lasts from one to several days. He is equipped and highly qualified to instruct in many levels of self-defense actions, as it relates to carrying a weapon, as well as when and how to use it for the best effect possible.

Stay tuned to our website [www.grpc-jax.com](http://www.grpc-jax.com) or follow us on Facebook, for future seminars with very interesting speakers available to you. I encourage you to tell your family, friends and neighbors about our facility and bring them out to experience some of what is new and wonderful at Gateway Rifle & Pistol Club.

# GRPC

DAY MEMBERS ----- WHERE TO SHOOT (Annual and Life Members also)

**Ranges 1 A-B-C-D** Pistols only with pistol calibers, Location: Far left (West) as you leave front office, 53 positions at 7/15 yards

**Range 2** Rifles at 25-50 and 100 yards and shotguns on select positions  
ANNUAL and LIFE MEMBERS

---

Both of above two ranges, # 1 and #2

**Range 3** Rifle 50-200 yards and Pistols with 10 inch Barrels or longer chambered for rifle cartridges

**Range 4A** Same as Range 3 except 100 yards only

**Range 4b** Rifles in rim fire 22 cal, 17 cal plus black powder rifles,

**Range 5 a-b-c-d-e-f** All Purpose ranges for Pistols and Rifles with Pistol Calibers

**Range 6** Shotgun Skeet Range with only #6 to #9 Shot

**Range 7 a-b-c-d-e-f-g-h** All Purpose ranges for Pistols and Rifles with Pistol Calibers  
25/50 Yard Pistol Match Range – Pistols and Rifles with Pistol Calibers

**Range 8** Rifle, 25, 50 and 100 yard Rifle targets

Rev 9/20/2014

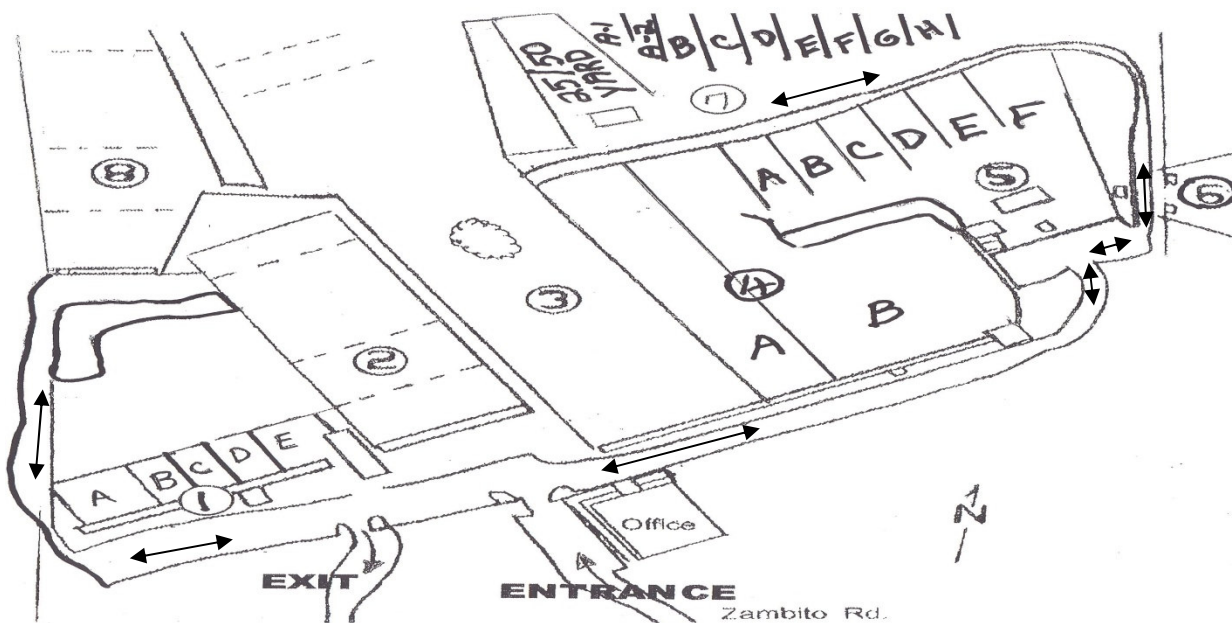

**GATEWAY RIFLE &PISTOL CLUB  
NRA APPROVED 1800 and 2700 CONVENTIONAL PISTOL MATCHES  
2015 TOURNAMENT SCHEDULE**

TOURNAMENT NAME: NRA Approved Conventional Pistol Tournament

1800 TOURNAMENT DATES: February 15, March 15, May 17, June 21, July 19, August 16, September 20, November 15, 2015

2700 TOURNAMENT DATES: January 18, October 18 and December 20, 2015

SPONSORING ORGANIZATION: Gateway Rifle & Pistol Club, Inc.  
9301 Zambito Road  
Jacksonville, FL 32210

FOR INFORMATION CONCERNING TOURNAMENT CONTACT: Randy Erickson  
9028 Latimer Road West  
Jacksonville, FL 32257  
904-448-3174

DIRECTIONS TO RANGE: From I-295 exit on 103<sup>rd</sup> Street, take 103<sup>rd</sup> west (towards Cecil Field) to Old Middleburg Road, turn right on Old Middleburg Road and go north about ½ mile to Noroad, turn left on Noroad and go about 1.2 miles to Zambito Road, turn right on Zambito Road and go about ½ mile to range on right, look for Club sign.

RULES: Current NRA Rules Apply

ENTRY FEE: \$15 for both 1800's and 2700's

ENTRIES: Mail NRA SR-1 card to Randy Erickson at above address prior to tournament (do not send match fees in advance) or register the day of tournament through 8:45 AM, if space available.

ENTRY LIMITS: The number of entries shall be limited to 25 competitors, preference shall be given to competitors who fire entire tournament

FIRING STARTS: Firing starts promptly at 9:00 AM

**Gateway Junior Shooters continue to excel in Air-Rifle Competition**

By Terry Pitts

The latest achievement is by Gateway Junior shooter Annie Davis who has made Distinguished Expert International Air-Rifle in the NRA / Winchester Qualification Program, the most prestigious award that can be earned. Very few shooters achieve this award and Miss Davis showed she had the ability and determination to do it.

The Winchester / NRA Marksmanship Qualification Program is a skill development program that provides incentive awards for developing and improving marksmanship skills. It has been the flagship of the NRA's training development programs since 1903. In the NRA / Winchester program the shooters are eligible to earn awards as their shooting skills progress. The courses of fire are designed to take the shooters from beginning skill levels (Pro-Marksman & Marksman) through intermediate levels (Marksman 1st. Class, Sharpshooter & Expert) up to the nationally recognized skill level and pinnacle of the program, Distinguished Expert.

All the Juniors participating in the Gateway Junior Shooters Program are eligible and encouraged to participate in the NRA / Winchester Program and are coached through all the skill levels by our volunteer group of instructor/coaches.

**Discipline Contacts:**

**IR 50/50 22 Benchrest**

Bill Smith 904-276-1008,  
work 904-790-6112.

**Smallbore Rifle Silhouette**

Hugh McCombs 904-309-1988

**IDPA**

Ed Sevetz 272-8484  
sevetze@bellsouth.net

**Club 1800 Bullseye**

Randy Erickson 448-3174

**High Power Rifle**

Marion Estes marionpestes@gmail.com

**3x20 Highpower Rifle Prone**

Joe Zullo 495-4109

**Black Powder Muzzle Loading**

Stan Goldy 904-410-1723

**NRA/1800 Bullseye**

Randy Erickson 448-3174

**NRA/2700 Bullseye**

Randy Erickson 448-3174

**Cowboy Action/SASS**

Jake Mehrman 904-316-0644

**Junior Shooters**

Marion Estes marionpestes@gmail.com

**Tournament Schedule**

| <u>Match</u>           | <u>Range</u>   | <u>Time</u> |
|------------------------|----------------|-------------|
| Club 1800 Pistol       | 7 1st Sunday   | 0900-1200   |
| Smallbore Silhouette   | 4 4th Sat.     | 1000-1400   |
| 22 Rimfire Benchrest   | 4 1st Sat.     | 0800-1300   |
| IDPA                   | 5 1st Sat.     | 0830        |
| High Power XTC         | 3 2nd Sunday   | 0800-1100   |
| Black Powder           | 4 2nd Sat.     | 0800        |
| High Power Rifle Prone | 3 3rd Sat.     | 0800-1100   |
| NRA 1800 Bullseye      | 7 3rd Sunday   | 0900-1200   |
| Cowboy                 | 5 4th Saturday | 0900        |

**Range Maintenance Schedule:**

**Mondays 8 am-11 am**  
100 yd. Rifle Range

**Tuesdays 8 am-11 am**  
all Pistol Ranges

**Wednesdays 8 am-11 am Silhouette Range**

**Thursdays 8 am-11 am**  
200 yd. Rifle Range

**Fridays 8 am-11 am**  
all multi purpose ranges  
New 100 yard rifle range

## Attention Pistol Shooters Join the fun at GRPC on the 1st and 3rd Sundays at 9:00 AM

Has it been a while since you shot your pistol or revolver? Do you remember the fun of shooting your pistol and enjoying a little range time with your friends and other shooters? Then this is your re-invitation to spending a couple of hours on the range and having some fun with your pistol.

GRPC holds two pistol events every month. On the first Sunday of the month, we meet at the 25/50 yard pistol range and begin shooting at 9:00 AM. We'll end by noon, just in time for lunch. We shoot the Florida Police Officer's Association (FPOA) course, which is 90 rounds, fired on paper targets at 25 yards for slow fire and 15 yards for timed and rapid fire. We begin with the .22 caliber pistol/revolver and then shoot the course again with a Center Fire pistol/revolver (.32 - .45 caliber). But not to worry, if all you brought was your .22, then you can shoot the course again. We call this the fun match, as our goal is to have fun and provide a venue that allows you the chance to shoot your match conditioned pistol or "out of the box" pistol with other beginner, or not so beginner shooters in a relaxed environment.

On the third Sunday of the month, beginning at 9:00 AM, we meet at the 25/50 yard pistol range to shoot a NRA "Bullseye" Pistol match. This match is traditionally shot one handed at 50 yards for slow fire and at 25 yards for times and rapid fire. While it's a little more challenging than the FPOA shoot, the different NRA classifications that are based on your ability, coupled with the new NRA pistol divisions offer anyone the opportunity to join in on the fun. We'll finish around noon and then head to lunch.

With the new NRA rule changes, shooters have the opportunity to register in up to three divisions, Production, Metallic and Open. In an effort to invite more shooters to try the sport of Precision Pistol, formally called Conventional Pistol, but more commonality known throughout the community as Bullseye Pistol, the NRA introduced the following three divisions. The Open Division includes any semi-automatic handgun or revolver using any sights, including telescopic, with the exception of those sights that project an image on the target. Like the Open Division, the Metallic Division includes .22 caliber, up to and including .45 caliber pistols and revolvers. As its name implies, the authorized sights are metallic, no optic sights are permitted. The pistol may also be match conditioned. There are a few other restrictions, and as with all pistols or revolvers, all standard safety features of the guns must operate properly. Finally, the Production Division - A Production Firearm is a semi-automatic handgun or revolver which is or has been a catalog item readily available to the general public equipped with factory notch & post sights. All standard safety features of firearms must operate properly. With a few exceptions, the firearm must have no visible internal or external modifications. The complete rules can be found at: <http://pistol-competition.nra.org/documents/pdf/compete/RuleBooks/Pistol/pistol-book.pdf>.

**If you are looking to start "Bullseye" style pistol shooting or get back into it and are not quite sure how to get started, contact Ted Carter, [cdrcoach@reagan.com](mailto:cdrcoach@reagan.com) or 904-880-1715. We are always looking for new shooters, old shooters, junior and women shooters and with the new rule changes, you probably have a pistol that you can use.**

See you at the range.



## GRPC to host the 2015 "Dixie Match" April 17, 18 and 19, 2015

Gateway Rifle and Pistol Club will again, host the Dixie Match in 2015. The match combines a NRA Regional Pistol Championship, NRA Distinguished Revolver Match, Civilian Marksmanship (CMP) Service Pistol Match and new for 2015, a CMP .22 RIMFIRE Pistol Match.

Gateway has hosted the Dixie Match for a number of years and the match has become one of the best "Bullseye" pistol matches in the southeast. The match attracts novice as well as experienced pistol shooters from all around the state, including competitors from neighboring states and shooters from more distant states including Maryland and New York. The dates for the Dixie's are April 17, 18 and 19.

The match will be held at the 25/50 yard pistol range. Members should expect a lot of vehicle and foot traffic during match hours at the back pistol bay areas.

Registration forms can be obtained in the office or online at <http://grpc-jax.com/events.html> or by e-mailing the Match Director at [cdrcoach@reagan.com](mailto:cdrcoach@reagan.com).

If you'd like to help out with the match or just want to know some more about "Bullseye" pistol shooting,  
Contact: Ted Carter ([cdrcoach@reagan.com](mailto:cdrcoach@reagan.com)).



**NRA Board of Director Elections.  
Deadline for receipt of ballots is March 22, 2015**

If you are a NRA Life Member or 5 Year Annual Member then you received your Official NRA Ballot inside NRA's February 2015 publications and you are a voting member. If you have already voted for your candidate(s) for the NRA Board of Directors, Thank You!! If you have not yet voted, the deadline for receipt of ballots is March 22, 2015...please take the time to look at the candidates, read their biographies and then mark your ballot and send it in.

One-third of the terms of office of 75 Directors expire at each Annual Meeting of Members. The 2015 election will fill the 25 three-year terms that expire in 2018. The 25 Candidates receiving the highest number of votes will be elected to three-year terms.

If you are an NRA member, then you know how important your support is and what power you and the other 5 million members have in ensuring our Second Amendment Freedoms. If you are not a voting member, then consider upgrading your annual membership so that you can join other NRA members in selecting the organization's future leaders.

If you are not a NRA member, find out more by checking out <http://home.nra.org/>

Submitted by Ted Carter,

Ted is a member of GRPC and is a member of the NRA Board of Directors.



**FOR SALE**

**Ruger Mini 14 Rifle** .223Rem/5.56 NATO. Stainless steel, synthetic stock. Barrel stabilizer and flash suppressor. Mounting points for flashlight or laser. M1 carbine rear sight and Tasco 3x9x32 scope in Ruger steel rings. 5, 20, and 30 round magazines included. Like new.

<http://www.grpc-jax.com/images/Mini14.jpg>

Price - \$799.00

Contact: Joe Zullo at [webmaster@grpc-jax.com](mailto:webmaster@grpc-jax.com) or cell# 904-495-4109

**Olympic Arms K8 Targetmatch Rifle**, 5.56 NATO, 24" bull barrel. Equipped with Nikon Buckmasters 6-18x40 scope with nikoplex reticle. Mounted with Burris PEPR scope mount, MFT pistol grip, DPMS rifle length handguard. Comes with Oly-Arms hard case, scope comes with box and small turrets. Excellent condition, absolute tac-driver.

Price - \$1100. 00 for complete package –Asking \$700.00 for rifle alone, Asking \$400.00 for scope and mount

Contact: Alan Byerly at 904-686-5215



**Gunpowder and Alcohol Fact**

From the 18th century until 1 January 1980, the United Kingdom measured alcohol content in terms of "proof spirit", which was defined as the most dilute spirit that would sustain combustion of gunpowder.

The term originated in the 18th century, when payments to British sailors included rations of rum. To ensure that the rum had not been watered down, it was "proved" by dousing gunpowder in it, then tested to see if the gunpowder would ignite. If it did not, then the rum contained too much water and was considered to be "under proof". Gunpowder would not burn in rum that contained less than approximately 57.15% alcohol by volume. Therefore, rum that contained this percentage of alcohol was defined to have "100° (one hundred degrees) proof".