

The MUZZLEBLAST

One of Florida's Largest Gun Clubs with well over 3,000 members

Volume 2023, Issue 3 ELECTION ISSUE

September 2023



2023 Annual Meeting

By Bill King, President

On Saturday November 4th we will have our annual meeting, election, swap meet and lunch (not in that order).

The swap meet will open at 7:30 in the Pavilion and go until the business meeting starts at 11:00. After that lunch will be served.

There will be presentations about our finances and this year's projects. We will have a speaker, who usually shares some interesting information, we have several people in mind for this year. There will also be time to talk to board members if you have any questions. We will also have a raffle. Good luck!

So, plan a day at the range. Usually, the weather is kind to us so after the meeting, you can do some shooting and maybe try out something you got at the swap meet. The Absentee Ballot and instructions can be found on pages 9 and 10. See you there.

Why Does Gateway Need to be Financially Strong?

By Randy Erickson

From time to time at the Annual meeting, folks will question if Gateway has "excessive cash" in the bank, so let's cover this subject in more detail than time would permit the Annual Meeting. In the last Annual Meeting, I talked about our cash on hand as a "financial reserve". Let's start by looking at what happened to some gun clubs that did not have strong financial reserves:

Example #1: About 30 years ago one of the old Bullseye shooters here at Gateway who moved here from up north told me about his home gun club in Harrisburg, Pennsylvania. They started the club in the boondocks outside the city and over the years, urban encroachment led to the club being encircled by developments. Well, when all the readily available land was gone, some developer started filing frivolous lawsuits against the club and even though the lawsuits were baseless and the club won the lawsuits, the club quickly ran out of money and went bankrupt. Guess who got the club land on the cheap?

Does this story apply to Gateway? You bet it does! Just look at the development that went in behind the church on the corner of No Road and Old Middleburg Road. It went from undeveloped woods to houses almost overnight. And closer to home, there is a strip of land just to the southeast of Gateway (on the east side of the city lot on the north leg of Zambito) where we just

received notice that it is being rezoned to residential. There is also about 30 acres of land that has been cleared and is ready for development just to the southwest of Gateway past the private gate at the west end of Zambito.

Example #2: When I lived in Rockford, Illinois before moving here, there was a little indoor pistol range, the Pine Tree Pistol Club, located downtown. Unfortunately for the club, right next door was a skating rink that catered to well-heeled folks who saw their daughters as the next Olympic gold medalists. These well-to-do folks decided they needed a bigger parking lot and since they had a lot of pull with the city council, guess what? The city seized the club land, bulldozed the building and paved it over.

How does this apply to Gateway? Many years back, a line item showed up on the city budget to develop Gateway into an "airpark" for Herlong Field. FYI, an air park is one of those fancy developments on the edge of an airport where every property comes with its own hanger, so you don't even have to drive to the airport to go flying, you just hop into your plane and taxi over to the runway. The short version of this story is that a few folks downtown thought Gateway was some little po-dunk gun club and when they found out how many members we had, the line item got deleted.

Example #3: My Dad is an avid shot gunner and shoots at several different clubs. One of the clubs has been around forever and prided itself on its low fees. He was paying \$2 per round of 25 birds back in the 1990s while I was paying about \$7-8 per round in town here. This club had saved about \$30,000 over many years and thought they had everything they needed. Then a bureaucrat from the state conservation commission came to them and told them about a new program where the state would match their funds with something like 4 or 5 to one

for facility improvements. Eventually the club decided they couldn't pass up on the "free money" so they contributed \$25,000 to a new \$100,000 plus club house. This left them with a whopping \$5,000 in reserve. Well guess what? Covid and the ammo shortage hit and shooting came to a standstill! Since the club's main source of income was based on rounds of birds shot at the range, they suddenly had a major problem paying for fixed costs like property tax and utilities!

How does this apply to Gateway? As I reported at a previous Annual Meeting, Gateway has also felt the pressure from Covid and the ammo shortage BUT, we have the financial reserves to weather this storm without cutting back services to our members, cutting employees and still make appropriate range improvements that will benefit our members.

So, what can we do to be able to weather these kinds of issues? Two things:

1) We need to stay financially strong so we can fight off anyone who would try to take our land. It would cost a developer a lot of money to take on Gateway in court and that makes us far less attractive for "hostile takeover". It also gave us the ability to purchase the two lots of land just to the south of us on Zambito, the heavily wooded lot on the corner and the one with two trailers. Even though we are grandfathered in by state law, this land provides noise abatement for our neighbors. Also, as much as we like our neighbors, we like them to be some distance from the club so there are less likely to be issues like kids trespassing on our property after hours.

2) We also need to have as many members as possible so we have political pull in the community. Most of our 3600+/- members are Jacksonville residents and that gives us a lot of pull with city council members.

One more thought on "excessive cash": Those of us over 50, and that is sadly most of us here at Gateway, suffer from not keeping up with the cumulative effects of decades of inflation. For example, I paid my way through college doing filthy, back breaking work on the farm and in construction working for \$2-3 per hour and I'm floored by folks making \$17.50 working at fast food joints. It's a bit like the Austin Powers movie where Dr. Evil has been in suspended animation since the 60's and after he has been resuscitated in current times, he hatches an evil plot and plans to ransom the government for a million dollars. His colleagues have to get him recalibrated to current times and tell him that a million dollars is really not that much money now days....

So, in summary, there is no downside for Gateway being financially strong and we've never heard of a club having problems by being too well off.

Maintenance

By Bill King, President

A shooting club like ours needs constant attention or it will fall apart. A small club usually has members do routine jobs. We have John, Don, Charles and Wendell to take care of us for things like:

- New target frames
- Mowing the lawn
- Filling holes in the roads
- Maintaining drainage; something very important in Florida.
- Repairing things that get shot up which shouldn't get shot up. This requires a lot of skill and we can see the results of their effort because when we come to the range, all we have to think about is how to have fun.

It's like elves come in and take care of things. Usually, we notice them when a range is temporarily closed to take care of routine repair. This is done by a schedule you see posted at the range and at the gate when you come in. One of the new routine repairs is fixing the arm to the gate when someone breaks it!

A lot of maintenance on equipment is now being done in-house. This saves both time and money. John Whitten and his crew are always looking for ways to save the club money by doing maintenance on our equipment and fabrication of fixtures that we, in the past, would have had to pay a third party to do. We also save in having the equipment back sooner as there is no travel back and forth to deliver and retrieve.

I'm sure there are a lot of things I have left out, but I want all of us to know how much work is done so we can have a place to shoot.

Thanks for reading.

Courtesy and Safety

By Bill King, President

These two things are essential at any shooting venue. During the Covid years, we had challenges in running the club and we looked forward to each new year as the one that would bring 'normal' back to us. Hasn't quite happened yet. We have managed well, and before the new problems, things seemed to be getting better.

Ammo is available, components, not so much. There are more shooters coming out and Daily Members have been coming back. So, let's look at a problem we can do something about. Incident reports.

In most cases, unsafe shooting or using a gun which is prohibited on that range starts the event. If a Range Officer or another member cautions the shooter and they settle down and aim, or move to a proper range, no

incident. When the shooter continues to misbehave or refuses to go to another range, it becomes an incident. They may think what they are doing is no big deal, or think it is a stupid rule. That doesn't matter. We are talking safety here. If they refuse to behave, they are asked to leave and an incident report is made. We have had to call police at times and we usually get prompt service. This is also done in case of theft. Sounding like the Geezer I am, I was on the old 25/50-yard line years ago when someone had left a shooting box sitting there. You know, the kind the Bullseye shooters use; had everything you'd need to compete in the box. I took it to the trailer and Warren called the guy and asked if he had forgotten anything. I think if that happened now, likely the box would be turned in; a lot of stuff is turned in lost and found and we try to locate the owner. Anyway, you'd want others to turn in your stuff. If they don't, we have video to see what happened.

Safety is what gets clubs closed down. We have invested a lot in the barriers to bullets getting out. The baffles, billboards, berms and deflectors all help and the need is confirmed when you see all the bullet marks in unlikely places. How many times have you noticed one of these and wondered...How did that get there? Well, our maintenance crew wonders exactly that and sometimes changes need to be made. A part of the baffle system is protection against the rounds that are likely to be used on a range. Some ranges are pistol. Some are rifle. Simple isn't it. Well, maybe not simple enough. The silhouette line is designed for .22 rimfire rifles and pistol rounds. Some of the pistol bays allow rifles using centerfire pistol cartridges, usually lever rifles. They can be used by AR platform rimfires but not bottleneck centerfire rifles. You may have noticed a lot of signs about this. If you aim at the target, use a combination that is safe on that range, the chances of a problem are reduced.

I'm sure you have noticed that the city is finding it's way here. There are new developments in progress all over and we want NOT to be a concern to our neighbors. The properties we have purchased the last two years are buffers to protect us from encroachment. We want to be good neighbors.

On courtesy, we want to be accommodating to other shooters. We ask if we can get a cold line, thanking the others when there is agreement. We don't ask for a cold line every 5 minutes to work our target. Be prepared to shoot when you come to the range. If someone isn't prepared and asks for help, do what you would want them to do were you in the same situation. When the line is cold, step back if you aren't going down range and don't mess with your firearms. If you aren't downrange and someone approaches the bench or the table their guns are on, caution them. I'm sure most have good intentions but accidents are reduced when no one is messing with guns when the line is cold.

The things we learn about safe shooting become good habits over the years and you do them without thinking. We've all seen someone on the line swing a gun when taking it off the line or maybe asking for help. DON'T do that! If you see it done, go to the shooter and explain gun handling to them. It takes a while but when a new shooter learns that all around them are practicing safe handling and gets comfortable being at the range, we have a new gun nut...that's what we hope for.

The more shooters there are the better!

Thanks for reading!

Gun Writer Myths #5, The New Colt Python

By Randy Erickson

For those of you who have not been following these articles in previous issues of the Muzzleblast, this is a series commenting on the overall poor technical content of most gun magazine articles. Much of what you are reading is a glorified advertisement designed to get you to buy the product and is all too often flat out technically wrong.

In this article, I'm going to share my thoughts on the "New" 2020 Colt Python and brace yourself, you are going to see some stuff here that you won't read in any of the gun magazine reviews.

For starters, I have to say I've always been a Python fan. I bought my first one in high school in the 70's and Dad was not thrilled that I spent \$400 on it given I made \$2/hr doing filthy, back breaking work on the farm. Since then, I've collected more than a few and shot them extensively, both back in the days of my youth (my magnum-mania phase) and while working on getting my NRA Distinguished Revolver Badge (#7!). I also worked on quite a few back when I was doing gunsmithing, so I actually have an informed basis for my opinions.

Anyway, a while back I bought a new "2020" Python and I just got around to checking it out. Here are the highlights just in case you haven't been reading the numerous magazine articles on it.

First of all, I have to say the finish is absolutely beautiful and it has some of the best machining I've ever seen on a firearm. Most stainless-steel revolvers like Smith and Wesson's (Smiths from here on) and Ruger's have a very fine brushed finish making the stainless steel look white. The Python has a much higher degree of polish

and an almost mirror like finish. I can actually see my reflection in the finish, not very well, but it's there. What you don't read about is the total absence of tool marks and the same polished finish in places where you wouldn't notice them anyway like inside the window for the cylinder in the frame, on the frame under the grips and on interior/unexposed surfaces of the hammer and trigger. These areas have the same high polish as the outside even though most folks will never really look there.

Colt also did a really great job of preserving the original classic profile and aesthetics. The only significant deviations are at the front of the trigger where it exits the frame, the lead into the cylinder notches, and the hammer spur is different. The grips are dark, laminated wood very close in profile to the originals (slightly narrower at the bottom which actually feels better to me) and they have an even better fit with the metal frame than the originals.

Colt also kept the silky-smooth action that Pythons are famous for. And, of course, as you've undoubtedly read, the new Python even has a much improved double action, certainly on par with or even better than Smiths.

Ok, enough swooning over the outside and the obvious awesomeness of the Python. Here's a summary of what's on the inside and you probably didn't read any of this in a magazine review.

First, let's talk about the bolt actuation. The bolt is the little "doo job" that pops up out of the bottom of the cylinder window to engage the cylinder notches and keeps the cylinder locked in place when firing. In the old Python, the bolt is actuated by a cam on the rebound lever working on a thin tang on the end of the bolt. The upside of the original approach is the bolt can be adjusted to drop right at the lead-in to the cylinder

notches and not drag around the circumference of your cylinder and make a nice (not!) witness mark around it. The downside is if that overly simplified explanation seemed complicated, you should look at the real parts and try adjusting them. In the new Python, the bolt is completely different and is actuated by the front of the trigger just like in a Smith. Since this approach can't be adjusted, the bolt drops well before the lead-in notch and makes a mark on the cylinder on Smiths and others. Colt addressed this by making the lead in notches really long so they cover almost the entire circumference of the cylinder. Each lead in goes almost from notch to notch. That's why the front of the trigger looks ever so slightly different and the lead in notches are longer. Most folks would never notice.

The old Python has a "safety" or hammer block so the hammer cannot touch the firing pin until the trigger is pulled, just like most (or all?) Smiths. In the new Python, the hammer cannot touch the firing pin until the trigger moves a "transfer" bar into place, like most (or all?) Rugers. Two parts replaced with one, both approaches are proven and work, enough said.

Next the hammer stirrup: It's the flippy "doo job" that hooks the hammer to the main spring. It and the notch on the V-shaped leaf style main spring that it hooks into has been changed so that 1) they are much easier to assemble/disassemble, and 2) there is now a single, robust hook on the mainspring. The old Python main spring had two small hooks that were fairly easy to break.

Oh yeah, one clown even stated that there are no MIMed (Metal Injection Molded) parts in the new Python. Well, he either never bothered to remove the sideplate or didn't know what he was looking at (or both) because I count at least 5 MIM parts in mine. Now there is nothing wrong with MIMed parts as long as they are

used in appropriate places and made with the right materials and heat treat. If you want to learn more about MIM, read up on it on the internet, I'm not going to cover it here. FYI, most firearms, even older designs, have used MIM parts for decades. In 2001, I went to a manufacturing trade show to evaluate potential processes and vendors for work and in the MIM area, numerous companies displayed dozens of MIMed parts that they made for all the big name firearms manufacturers.

Another change is instead of using two tiny little pins where the ratchet engages and turns the cylinder, there is a triangular contour where the ratchet nests inside the cylinder to drive it. Most revolvers went to this approach years ago, eliminating the tiny pins that can pull out or shear off.

OK, so far so good. Everything up to this point is either neutral or improved over the originals. Now in the spirit of a late night talk show, here is my list of the top things that Colt got wrong on the new Python.

Number 5: They used #4 screws on the side plate. The originals as well as most other revolvers with side plates use #6's which are much more robust. Colt had a recall on early Pythons caused by mis-torquing the side plate screws and the plates coming loose. #4's are so small that they are always on the fine line between coming loose due to too little torque or being sheared off by too much. My prediction is a lot of these are going to be sheared off over time and they will cause many heartaches.

Number 4: The "user-interchangeable front sight" (Colt's exact words) is held in with a #4-40 set screw. The originals had either one or two cross pins and were not particularly easy to replace so this was supposed to be an improvement. Problem is 4-40 set screws use a tiny

Allen wrench that is only .050 inch wide. Even using my hardened steel, made in America (1970's) Chapman hex insert and substantial heat on the end of the barrel, I stripped my set screw hex. To get it out, I had to file down a .062 wrench to .055, cut off the angled end and hammer it into the set screw to form a new hex, and then apply A LOT OF HEAT AND TORQUE to finally get it out. Turns out this is a fairly common problem and is a common subject in internet chat rooms that talk about the new Python. Not sure if the problem is Colt doesn't know that there are thread adhesives designed specifically for small, fine thread fasteners or if the Cro-Magnon man union assembler doesn't know how to use a torque wrench. Either way, a #6 set screw would have been a better choice.

Number 3: The improved but close to original profile grips noted above have a fairly sharp radius between the sides and the radius just in back of the trigger guard which I found to be very uncomfortable. The originals had a significant radius here. This is a pretty big miss from an ergonomics standpoint. If I had kept these grips on the gun, I would have ground this out and refinished the grips but instead put Hogue Monogrips on the gun. Problem solved.

Number 2: The single action trigger pull stinks! Everyone goes on and on about the double action pull (which is really good), but I only saw one reference in a magazine regarding the SA pull and the guy claimed it was a crisp 4 lbs, which would be a bit heavy but acceptable. Unfortunately, most of them, including mine, are a good hard 6 lbs and not remotely "crisp". In fact, you could see the hammer being cammed back against the mainspring when pulling the trigger slowly. Now, there are all kinds of excuses for this in the internet chat rooms. One theory is poor Colt supposedly had to meet some unrealistic California drop test. To that I say: make a special California model! Others claim that new owners

complained the new Python wouldn't fire cheap foreign made ammo with hard primers. Mine still fires 38's loaded with small rifle primers after taking it down to 4 lbs so I'm not buying that excuse either. Bottom line is this trigger is simply unacceptable on a \$1500 premium hunting or target shooting revolver! It's pretty sad when a \$400 rack grade 1911 made in the Philippines or a 1980's Ruger Redhawk has a better factory trigger pull than a Colt Python.

Number 1: The rear sight is a total joke! So, the sight picture is ok and the elevation screw is normal, BUT, the windage screw has no detents or clicks. That's right, when you want to adjust for windage you have to start turning on the screw and guess how much you moved it. To help you with that, Colt put 3 dots on the sight body and 1 dot on the blade so you can use that highly accurate measurement system to gage your adjustment (sarcasm alert: movement of the one dot relative to the other 3 is hardly an accurate way to adjust your sight). So, if you happen to get the sight where you want it, then you are supposed to lock it down with another, you guessed it, #4-40 set screw and a .050 in Allen wrench (not included with the \$1500 revolver). There, now that the sight is locked down, try this little experiment: put your handy dandy screwdriver into the windage screw and GENTLY turn it back and forth. You will find that it has over a half of a turn of backlash or slop in it. This means that when you are attempting to make say an eighth or quarter turn of adjustment on the sight (once you've loosened the set screw), you really don't know if the sight is moving or not and if you've actually corrected your zero.

At this point, I figured I could still fix this as it's not that big of a deal to change out the ever more common cheap sights that come on today's guns. (Yeah, just compare the sights on the new Ruger Mark 4 to the old Mark I and II's to see what I mean.) Looking at my new

Python, it looked like I'd be able to remove the factory sight and be able to install an old Colt Accro or better yet an Elliason premium target sight. After removing the factory sight, I was in for a shock. The body of the new sight is much thinner than the old Colt so the sight recess is much shallower. They also left a funky "rib" in the recess where the cross pin goes AND they changed the elevation screw from an almost industry standard #6 screw to a #4! Now it happens to be a 56 thread per inch, not 40, but it's still a crappy #4. Notice a common theme here? So bottom line is Accro or Elliason sights won't drop in. But on the brighter side, I now made the connection with the statement in the Colt advertisement: "Thirty percent more steel beneath the adjustable rear sight gives you a stronger revolver....." They also mention they redesigned the rear sight but don't say why. By this point, I'm having some pretty major heartburn over this stupidity. First off, I calculated the change in area and didn't find 30% more steel. Second, a stress calculation on that part of the frame shows really low stresses so it didn't really need any added material there anyway and that is consistent with the Python's reputation for having a stout frame. (We'll talk about the Python's lockwork later...) As far as the funky rib goes, I can only speculate as to why it's there. My Anaconda is factory drilled and tapped in two visible places on the top strap for a scope mount and, if you take the rear sight off, there is a third drilled and tapped hole under the sight in the middle of the rib. The new Anaconda and new Python use the same "redesigned" rear sight and I assume they just kept the machining for the recess the same between them.

By this point I'm more than a little peeved with this crappy rear sight and I'm seriously considering milling out the recess and re-drilling and tapping my \$1500 new revolver so an Elliason sight will fit. Just as I'm about to start laying out machining dimensions, I thought others

must be equally dissatisfied with this sight so I did an Internet search. After numerous search queries, I found that Wilson Combat makes a drop in adjustable sight for the new Python and Anaconda for something around \$120. (Turns out search queries often need just the right wording to find what you are looking for. Sort of like dealing with engineers in design reviews, you have to ask the perfect question to get them to blurt out the truth.) Installing the Wilson sight was super easy and it is basically on par with the very nice Elliason sight. Problem solved!

So, there you have it. In spite of the above problems, I really like my new Colt Python. In fact, I really hope that Colt resurrects the Diamondback (the Mini-me version of the Python with the scaled down frame) in both 38 and 22. Six shot versions please, the 10-shot cylinder on the new King Cobra 22 is a monstrosity. I just hope they get their act together and fix the above issues. Also, everything I noted above applies to the Colt Anaconda except for the grips, it already comes with a very comfortable Hogue style monogrip.

In the next issue of the Muzzleblast, I'm going to continue with the Python theme and write about the Python action's durability, reputation vs. reality, and its reputation for accuracy. Stay tuned for more stuff that you won't see in a magazine.



2023 ABSENTEE BALLOT FOR ELECTIONS
GATEWAY RIFLE & PISTOL CLUB

OFFICER POSITIONS

Vote for ONLY ONE (1) candidate per position. Indicate your vote by **CIRCLING the name of candidate or CLEARLY PRINT the name of write-in candidate**. Write in votes will be counted only if the candidate has declared intention to run to the Club Secretary or Business Manager prior to the election. Eligibility for officer positions requires one year service on the Board of Directors prior to the election.

President Bill King	Write In: _____
Vice President William Edwards	Write In: _____
Secretary Randy Erickson	Write In: _____
Treasurer Sue Carter	Write In: _____
Public Relations Officer Charles Preston	Write In: _____

DIRECTOR POSITIONS

Indicate your vote by **CIRCLING the name of the candidate(s) or CLEARLY PRINT the name of the write-in candidate(s)**. Write in votes will be counted only if the candidate has declared intention to run to the Club Secretary or Business Manager prior to the election. This election, there are three 3 year Board of Directors (BOD) positions open. The top three candidates with the most votes get the three-year positions on the BOD.

VOTE FOR ONLY THREE (3) DIRECTOR POSITIONS

Carl Berg * Write In _____

Walt Gallahan * Write In _____

Don Hardeman Write In _____

Wade Ollier * Write In _____

* Denotes Incumbent Candidates

Clearly print name of Club Member

Signature of Club Member

NOTARY SEAL AND SIGNATURE, IF MAILED IN:

Detailed instructions are printed on reverse side

ABSENTEE BALLOT INSTRUCTIONS

1. Absentee ballots may be completed at the Club office. Club members will write or mark their choices on the ballot, including possible write in candidates. The ballot will be folded to insure privacy and placed in a plain white envelope supplied by Club office personnel. The Club office person receiving the sealed ballot will verify the Club member active status. The words "Absentee Ballot" will be written on the front of the envelope. On the backside of the envelope will be written the printed name and signature of the Club member on one side of the flap and the printed name and signature of the Club employee or Club official receiving the ballot will be on the opposite side of the sealed flap. These ballots will be placed in the ballot box and secured until the elections.

2. Absentee ballots may be mailed to the Club.

- a. Blank ballots are printed in the Muzzleblast and are online at our web site.
- b. Blank ballots are available in the Club Office.
- c. Blank ballots may be mailed to Club members upon request to Club office personnel.

The Club member will write or mark his/her choices as well as possible write-in candidates on the ballot. The club member will print his/her name and sign his/her signature on the ballot. The signature however, must be verified by a Public Notary with the Notary's name and seal on the ballot. The Club member will mail the ballot to the Club to the attention of the Club's Secretary with the words "ABSENTEE BALLOT" plainly written on the face of the mailed envelope.

Gateway Rifle and Pistol Club
ATTN: Absentee Ballot
9301 Zambito Avenue North
Jacksonville, FL 32210

3. Regular printed ballots will be on hand at the annual election on 4 November, 2023. Any qualified person who announces his/her availability after 13 September will be on the regular printed ballot.

4. The BOD terms for Carl Berg, Walt Gallahan and Wade Olyer end on 31 December 2023. The BOD terms for Tim Allen, Gary Kight, and Doug Havens end on 31 December 2024. The BOD terms for Alan Rosner, Tim Hardy, and William Todorsky (Willy Wiskers) end on 31, December 2025.

5. This election: there are three 3 year BOD positions open and as of 9/13/23 there are 3 declared candidates.

Where To Shoot What At Gateway

By Randy Erickson

DAY MEMBERS and ANNUAL / LIFE MEMBERS: RANGES 1 & 2

RANGE 1, PISTOLS and REVOLVERS: Located to far left as you exit the club store.

No rifles or shotguns allowed

NO FIRING OF HIGH POWER RIFLE ROUNDS (i.e. 223, 556, 7.62x39, 308, etc.) ALLOWED ON RANGE 1

RANGE 2, as follows: Located slightly left as you exit the club store.

BENCH SHOOTING ONLY

RIFLES, CARBINES, AR and AK style pistols with arm brace: All positions except 27 & 28: All calibers including rimfires, pistol calibers, high power/centerfire calibers, and black powder. AR and AK pistols must be fired supported from bench.

SHOTGUNS with shoulder stocks:

Positions 1-26: For shotguns with iron sights or optics, i.e. not a "bead" only front sight and must shoot slugs or turkey loads
Position 27: This position is for "patterning" birdshot loads. Ammunition must be #6 through #9 shot.

Position 28: This position is for function checking. Ammunition must be #6 through #9 shot.

SHOTGUNS without shoulder stocks:

Position 28 only: This position is for function checking. Ammunition must be #6 through #9 shot.

ANNUAL AND LIFE MEMBERS ONLY: RANGES 3-8

PISTOLS AND REVOLVERS:

RANGES 5 and 7 including the 25/50-yard Bullseye range: Pistol caliber ammunition only.

NO FIRING OF HIGH POWER RIFLE ROUNDS (i.e. 223, 556, 7.62x39, 308, etc.) ALLOWED ON RANGES 5 and 7.

RANGE 4B: Barrels must be 2 inch minimum length. Pistol caliber ammunition only.

NO FIRING OF HIGH POWER RIFLE ROUNDS (i.e. 223, 556, 7.62x39, 308, etc.) ALLOWED ON RANGE 4B.

RANGE 4A: Barrels must be 10 inch minimum length.

HIGH POWER RIFLE CALIBER ROUNDS ARE NOT ALLOWED.

RANGE 3: Must be capable of accurate fire at 200-yards.

High power rifle caliber rounds ARE allowed.

AR15 AND AK47 STYLE PISTOLS WITH ARM BRACE:

RANGES 2, 4A, and 8: Must be supported/aimed fire from bench. High power rifle caliber rounds ARE allowed on Ranges 2 and 8, **PISTOL CALIBER AND BLACK POWDER ONLY ON 4A.**

HIGH POWER RIFLES:

RANGES 2 and 8: Firing allowed sitting at bench only.

RANGE 3: Firing allowed standing, sitting, prone and sitting at bench.

PISTOL CALIBER AND BLACK POWDER RIFLES AND CARBINES:

includes .17 and .22 Rimfire, .38, .44 and .45 but not .223, .556, 7.62x39, 30-30, 308, etc.

RANGES 2, 3, 4A, 4B, 5, 8, and 7 including 25/50-yard Bullseye line.

SHOTGUNS:

RANGE 6: Use clay pigeon targets and birdshot ammunition with #6 through #9 shot. Slugs, buckshot and #4 shot not allowed. **NO RIFLES OR HANDGUNS ALLOWED.**

RANGES 5 and 7: Use with paper targets, clay pigeon targets not allowed.

ARCHERY: RANGES 5 and 7

See the next page for a range map and details on the different ranges

RANGE MAP

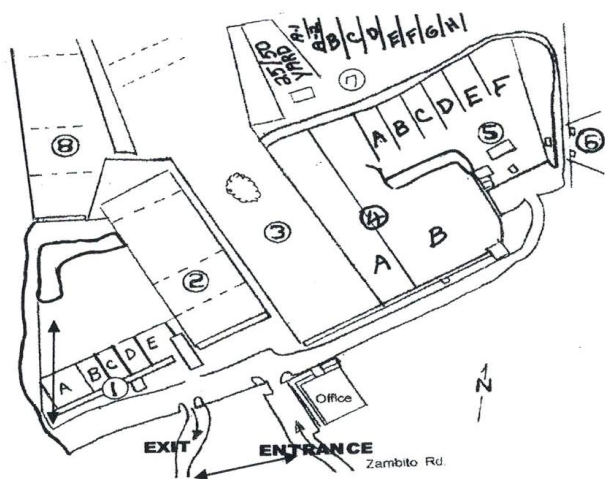

Range Details:

Range 1: 7- and 15-yard pistol range, **Day members allowed**

Range 2: 100-yard line primarily for rifles, **Day members allowed**

Range 3: 200-yard line primarily for rifles

Range 4A: 100-yard line primarily for rifles, **pistol calibers and black powder only**

Range 4B: Silhouette range, **pistol calibers and black powder only**

Range 5: General purpose bays, **pistol calibers, black powder and shotgun only**

Range 6: Shotgun with birdshot only, **no pistols, black powder or rifles**

Range 7: General purpose bays, **pistol calibers, black powder and shot gun only**

NOTE: FIRING OF "HIGH POWER" RIFLE AMMO LIKE AR/AK .223, 5.56 OR 7.62x39, etc. ON THE 4B SILHOUETTE RANGE, OR RANGES 5, 6 AND 7 WILL LIKELY RESULT IN LOSS OF MEMBERSHIP

CLUB INFORMATION

Gateway Rifle & Pistol Club

9301 Zambito Ave. N
Jacksonville, FL 32210

904.771.2937

www.GRPC-JAX.com

Where to Shoot

Day Members or Annual and Life Members

Ranges 1 A-B-C-D: Pistols only with pistol calibers. Location: Far left (West) as you leave front office, 53 positions at 7/15 yards

Range 2: Rifles at 25-50 and 100 yards and shotguns on select positions

Annual and Life Members Only

Both of above two ranges, #1 and #2

Range 3: Rifle 50- and 200-yards and Pistols with 10 inch Barrels or longer chambered for rifle cartridges

Range 4A: Same as Range 3 except 100-yards only

Range 4B: Rifles in rim fire .22 cal, .17 cal plus black powder rifles

Range 5 A-B-C-D-E-F: All-purpose ranges for Pistols and Rifles with Pistol Calibers

Range 6: Shotgun Skeet Range with only #6 to #9 Shot

Range 7 A-B-C-D-E-F -G-H: All Purpose ranges for Pistols and Rifles with Pistol Calibers, 25-/50-Yard Pistol Match Range, Pistols and Rifles with Pistol Calibers

Range 8: Rifle, 25-, 50- and 100-yard Rifle targets

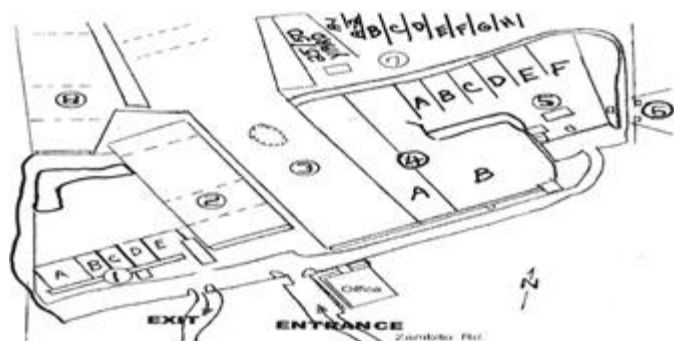

ID BADGES

All Shooters:

Annual, Life, and Day Members must wear ID badges at all times when on the Club property.

2023 Slate of Officers

Officer	Name	Contact Info
President	Bill King	pres@grpc-jax.com
Vice President	William Edwards	
Secretary	Randy Erickson	
Treasurer	Susan Carter	
Public Relations Officer	Charles Preston	

2023 Board Members

Tim Allen	Gary Kight
Carl Berg	Wade Olyer
Walt Gallahan	Alan Rosner
Tim Hardy	William Todorsky
Doug Havens	
Emeritus Directors:	
Bill Craig	
Sam Grimes	
Allen Way	

Range Maintenance Schedule

Day	Time	Range
Monday	0800-1100	100-yard Rifle Range
Tuesday	0800-1100	All Pistol Ranges
Wednesday	0800-1100	Silhouette Range
Thursday	0800-1100	200-yard Rifle Range
Friday	0800-1100	All Multi-Purpose Ranges and
		New 100-yard Rifle Range

Note: Subject to change based on maintenance need

Gateway Rifle & Pistol Club, Inc.

A private Club operated since 1965, providing a safe environment for the sport of shooting. We offer annual memberships allowing unlimited use of the shooting ranges and daily memberships for the occasional shooter limited to certain ranges. The Club is open 7 days a week from 8:00 am until near dusk except Easter, Thanksgiving, and Christmas. There are numerous pistol ranges at various distances for shooting paper targets and steel plates. The rifle ranges provide 25, 50, 100, and 200 yard shooting positions. For those interested in competition there are monthly matches for small bore, black powder, .22 50/50 Benchrest, bullseye pistol, 3x20 prone, NMC and Cowboy, etc.

There is an active junior program and women's program. The facilities include the rifle and pistol shooting positions, a large club house, meeting rooms, and a store selling those items you may need at the range including targets, ammunition, and eye and ear protection. There is a Range Safety Officer on duty at all times.

Tournament Schedule:			
Match	Range	Day	Time
ARA Rimfire	4B	3 rd Friday	Call range
Smallbore F-class	4A	1 st Saturday	0800-1100
22 Rimfire Benchrest	4B	1 st Saturday	1000-1400
Club 1800 Pistol	7	1 st Sunday	0900-1200
High Power Rifle Prone	3	2 nd Saturday	0800-1100
Black Powder	4	2 nd Saturday	0800-1100
High Power Rifle XTC	3	2 nd Sunday	0800-1100
NRA 1800 Bullseye	7	3 rd Sunday	0900-1200
Concealed Pistol/Home Defense Shotgun Match	5	3 rd Sunday	0900-
Smallbore Silhouette	4	4 th Saturday	0800-1400
Cowboy	5	4 th Saturday	0900-

Note: The above schedule is periodically subject to change: please check the website

Disclaimer

The Muzzleblast is published bimonthly by Lori Hallauer under the direction of the Gateway Rifle & Pistol Club. All newsletter content to be approved by the GRPC prior to publication. Technical and/or handloading data are for informational purposes only. No responsibility is accepted for results obtained by persons using such data, and all liability for any consequential injuries or damages is disclaimed. References herein to any specific commercial product, process or service by trade name, trademark, manufacturer or otherwise, does not necessarily constitute or imply endorsement, recommendation or favoring by The Gateway Rifle & Pistol Club, Inc., its Board of Directors, its membership, the editor, nor the Publisher. Letters to the editor should be brief, to the point, of firearm-related interest and contain the signature, address and telephone number of the sender. Letters to the editor do not necessarily reflect the views of the editor, publisher or Gateway Rifle & Pistol Club. Send submissions to: Gateway Rifle & Pistol Club, 9301 Zambito Rd., Jacksonville, FL 32210 or to the Muzzleblast editor at: muzzleblasteditor@grpc-jax.com.

Thank you for reading! If you would like to submit information, articles, or match scores, please send them to:

Bill King at pres@grpc-jax.com or
Lori Hallauer at muzzleblasteditor@grpc-jax.com.

Disciplines/Contacts:
IR 50/50 22 Benchrest Russ Ost RussOst@bellsouth.net
Smallbore Rifle Silhouette Grit Preston Adam Smith 904.545.9435 904.801.6451
Single Action Shooting Society (SASS) Vivian Allen-Parido vivianallenmd@aol.com
High Power Rifle Marion Estes marionestes4952@gmail.com
3x20 High Power Rifle Grit Preston 904.545.9435
Black Powder Muzzle Loading Stan Goldy 904.859.8887
NRA/1800 Bullseye/2700 Bullseye Ted Carter 904.880.1715 or cdrcoach@reagan.com
Pellet Silhouette Mike Hicks 904.304.2265
Cowboy Action Vivian Allen-Parido vivianallenmd@aol.com
Junior Shooters Marion Estes marionestes4952@gmail.com
Smallbore F Class Emil Albertini 904.759.8672 or ejalbertini@comcast.net
Women's Programs Sue Carter 904.880.1715
Concealed Pistol/Home Defense Shotgun Willy Todorsky Willywhiskers@yahoo.com
Black Gun Owners and Education (BGOE) Jeffrey Howell 813.304.9774
ARA Rimfire Robert Atkinson, Mike Roy, or John O'Brien gatewayrimfire@gmail.com